

Technical Data

Luffing Capacities

348

HYLAB

SERIES 2

Luffing Attachment

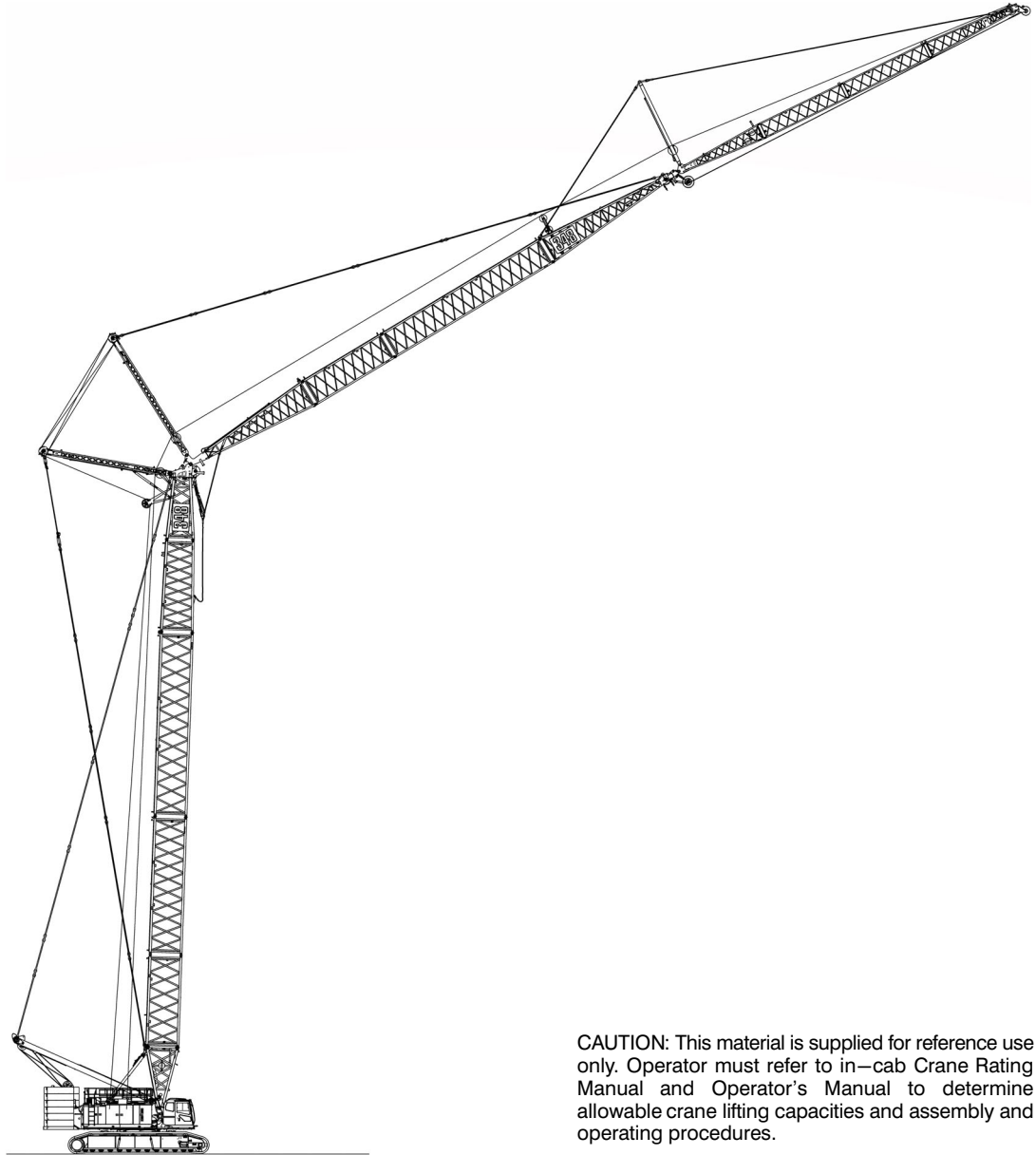

CAUTION: This material is supplied for reference use only. Operator must refer to in-cab Crane Rating Manual and Operator's Manual to determine allowable crane lifting capacities and assembly and operating procedures.

Attachment and Options

Heavy Duty Boom 70–300 ft (21.34–91.44m)

Basic Boom

70 ft (21.34m) four–piece design that utilizes a 15 ft (4.57m) base section, 20 ft (6.10m) base extension, 20 ft (6.10m) tapered extension, and 15 ft (4.57m) top section with in–line connecting pins on 95 in (2.41m) wide and 80 in (2.03m) deep centers.

- Boom foot on 56.50 in (1.44m) centers
- 6 in (15.24cm) diameter tubular chords on base section and top section
- 5.25 in (13.34cm) diameter tubular chords on extensions
- Boom connecting pins stored on base section
- Boom walkway
- Offset head sheaves
- Heavy duty boom tip section also acts as luffing boom top section
- Permanent stands mounted on top section to protect head machinery
- Seven 23 in (0.58m) root diameter polyamide sheaves mounted on sealed anti–friction bearings
- Tip extension, fixed jib, and luffing jib connecting lugs on top section
- Mechanical boom angle indicator

Heavy Duty Boom Extensions

The following table provides the lengths available and the suggested quantity to obtain maximum boom.

Heavy Duty Tube Boom Extensions		Quantity For Max Boom
ft	m	
“JC” Heavy Duty Boom		
20	6.10	2
30	9.14	1
40	12.19	4

- Midpoint pendant connections are required at 165 ft (50.29m) for boom lengths 250 ft (76.20m) through 300 ft (91.44m).
- Polyamide wear blocks on top of each extension
- Appropriate length bar pendants stored on extension
- Maximum tip height of 305 ft (92.96m)
- Boom connecting pin storage on each extension

Long Range Boom 85–355 ft (25.91–108.20m)

Basic Boom

85 ft (25.91m) four–piece design that utilizes a 15 ft (4.57m) base section, 20 ft (6.10m) base extension, 20 ft (6.10m) tapered extension, and 30 ft (9.14m) long range top section with in–line connecting pins on 80 in (2.03m) wide and 68 in (1.73m) deep centers.

- Boom walkway
- Boom connecting pins stored on base section
- Six 21 in (0.53m) root diameter polyamide sheaves mounted on sealed anti–friction bearings
- Tip extension and fixed jib connecting lugs on top section
- Long range boom is luffing jib for luffing attachment

Long Range Boom Extensions

The following table provides the lengths available and the suggested quantity to obtain maximum boom.

Boom Extensions		
ft	m	Quantity For Max Boom
“JC” Heavy Duty Boom		
20	6.10	1
30	9.14	1
40	12.19	2
“FE” Long Range Boom		
10	3.05	1
20	6.10	1
30	9.14	1
40	12.19	2

- Midpoint pendant connections are required at 165 ft (50.29m) for boom lengths 225 ft (68.58m) through 355 ft (108.20m).
- Polyamide wear blocks on top of each extension
- Appropriate length bar pendants stored on extension
- Maximum tip height of 360 ft (109.73m)
- Boom connecting pin storage on each extension

Fixed Jib 40–140 ft (12.19–42.67m)

Basic Tube Jib

40 ft (12.19m) two–piece design that utilizes a 20 ft (6.10m) base section and a 20 ft (6.10m) top section with in–line connecting pins on 48 in (1.22m) wide and 39 in (0.99m) deep centers.

“EF” Jib Extensions		Quantity For Max Jib
ft	m	
20	6.10	5

- 3 in (7.62cm) diameter tubular chords
- Boom connecting pins stored on base section
- One 23 in (0.58m) root diameter steel sheave mounted on sealed anti–friction bearings
- 20 ft (6.10) jib extensions are available to provide jib lengths of 40–140 ft (12.19–42.67m) in 20 ft (6.10m) increments
- Jib offset angles at 5°, 15°, and 30°
- The maximum tip height of tube boom + jib [275 ft + 140 ft (83.82 + 42.67m)] is 420 ft (128.02m).
- Can be used as fixed jib on luffing attachment
- Boom connecting pins stored on each extension

Long Range Auxiliary Tip Extension

Long range auxiliary tip extension can be mounted on the top section of the long range boom to provide clearance between working hoist lines. The extension is equipped with one polyamide 21 in (0.53m) root diameter sheaves mounted on sealed anti–friction bearings. Maximum capacity is 20 Tons (18.14mt).

Heavy Duty Auxiliary Tip Extension

Option heavy duty auxiliary tip extension can be mounted on the top section of the heavy duty boom, to provide clearance between working hoist lines. The extension is equipped with one polyamide 23 in (0.58m) root diameter sheave mounted on sealed anti–friction bearings. Maximum capacity is 35 tons (31.75mt).

Luffing Boom 130–200 ft (39.6–60.96m)

- Common base, base extension, tapered extension, top section, and extensions with heavy duty conventional boom
- Working angles of 88°, 85°, 80°, 75°, 70°, and 65°
- Working lengths of 130 ft (39.6m) to 200 ft (61.0m)
- Rear drum becomes luffing jib hoist
- Optional third drum provides second load hoist
- Designed for self-assembly
- Job site mobility with attachment
- Compact transport module
- Boom walkway and pendant storage

Luffing Boom Extensions

The following table provides the lengths available and the suggested quantity to obtain the maximum luffing boom. Midpoint pendants are not required.

Luffing Boom Extensions		Quantity For Max Luffing Boom
ft	m	
“JC” Heavy Duty Boom		
20	6.10	2
30	9.14	1
40	12.19	2

Luffing Jib 100–240 ft (30.5–73.2m)

Basic Luffing Jib

The minimum luffing jib for the crane is 100 ft (30.5m) and consists of a 30 ft (9.1m) “JE” base section combined with 40 ft (12.2m) “FE” extension and a 30 ft (9.15m) “G” luffing jib top section. The extensions are held together by four pins, in-line with the chords. Additional extensions are available in 10, 20, 30, and 40 ft (3.05, 6.1, 9.1, and 12.2m) lengths and can be combined with the basic luffing jib to form a maximum length of 240 ft (73.2m).

- Working lengths of 100 ft (30.5m) to 240 ft (73.2m)
- Top section includes mounting lugs for fixed jib
- Pin-on nose wheel
- Bar pendants stored on top of luffing jib extensions
- The maximum boom length of luffing boom + luffing jib [180 ft + 240 ft (54.9m + 73.2m)] is 420 ft (128.0m)
- Boom walkways

Luffing Jib Extensions

The following table provides the lengths available and the suggested quantity to obtain the maximum luffing jib. Midpoint pendants are not required.

Luffing Jib Extension		Quantity For Max Luffing Jib
ft	m	
“FE” Boom Extensions		
10	3.05	1
20	6.10	1
30	9.14	1
40	12.19	3

Fixed Jib 60–80 ft (18.3–24.4m)

Basic Tube Jib

60 ft (18.3m) and 80 ft (24.4m) fixed jib lengths are permitted for the luffing attachment. They consist of a 20 ft (6.1m) base section, a 20 ft (6.1m) top section, and 20 ft (6.1m) extensions to meet desired length. The extensions are held together by four pins, in-line with the chords. Fixed jib utilizes a 5° offset angle.

- The maximum boom length with fixed jib is luffing boom + luffing jib + fixed jib [160 ft + 210 ft + 80 ft (48.77m + 64.01m + 24.38m)] is 450 ft (137.16m)
- The maximum tip height is 450 ft (137.16m)

Boom/Luffing Boom

15 ft (4.57m) Boom Base

Section "N" 1

Length	15 ft 1.67 in	(4.57m)
Width	8 ft 6 in	(6.2m)
Deep	80 in	(2.03m)
Height	8 ft 4.50 in	(2.55m)
Weight	8,412 lb	(3 816kg)

Note: Weight includes backstops and walkway.

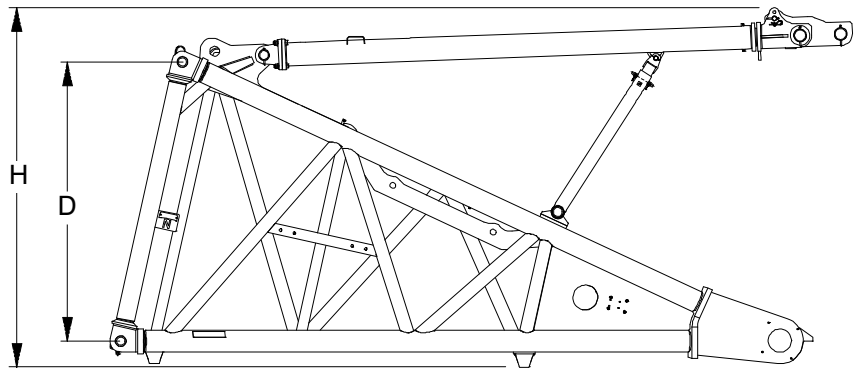
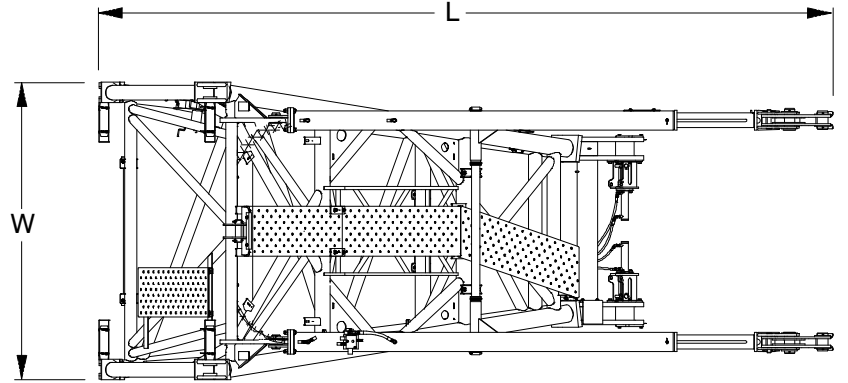

20 ft (6.10m) Base Extension "JT" 1

Length	20 ft 5.75 in	(6.10m)
Width	8 ft 5.75 in	(2.58m)
Deep	80 in	(2.03m)
Height	7 ft 9.84 in	(2.38m)
Weight	4,695 lb	(2 130kg)

Note: Weight includes pins, boom and rear post pendants, and walkway.

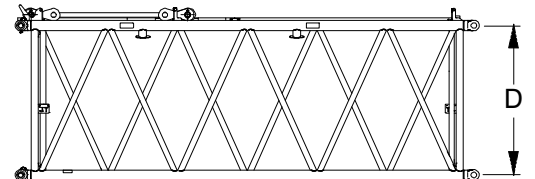
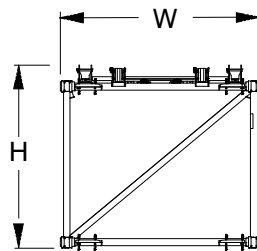
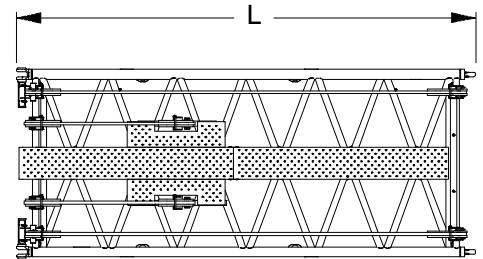

Number inside black circle "1" = # of components

Boom/Luffing Boom

20 ft (6.10m) Tapered

Extension "JR" ❶

Length	20 ft 5.75 in	(6.10m)
Width	8 ft 4.25 in	(2.55m)
Deep	80 in	(2.03m)
Height	7 ft 10.42 in	(2.34m)
Weight	5,797 lb	(2 630kg)

Note: Weight includes pins, boom and rear post pendants and walkway.

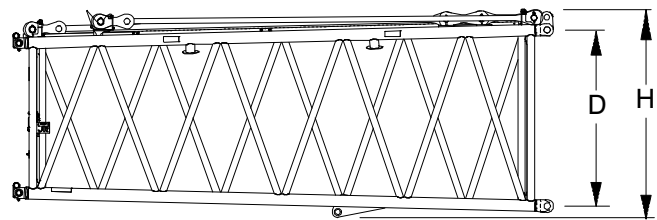
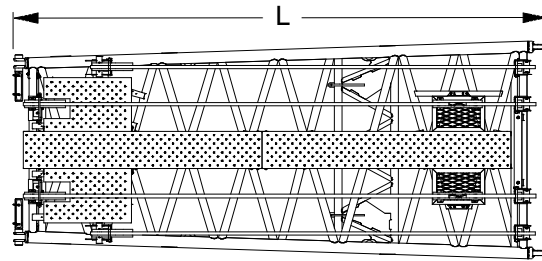
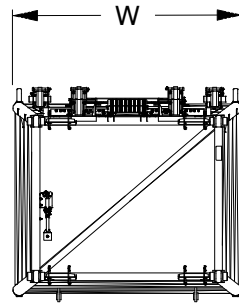

15 ft (4.57m) Heavy Duty Top Section "N" ❶

Length	15 ft 1 in	(4.57m)
Width	7 ft 2 in	(2.2m)
Deep	68 in	(1.7m)
Height	10 ft 9.4 in	(3.3m)
Weight	9,343 lb	(4 238kg)

Note: Weight includes pins pendants and back stops and walkways.

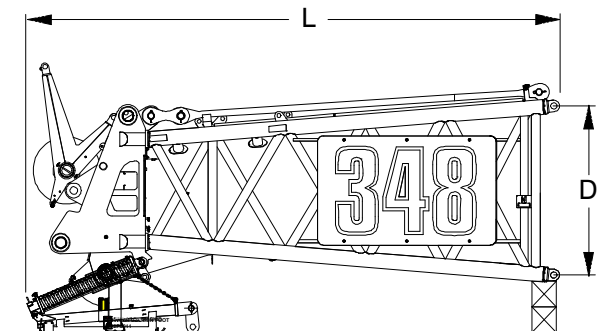
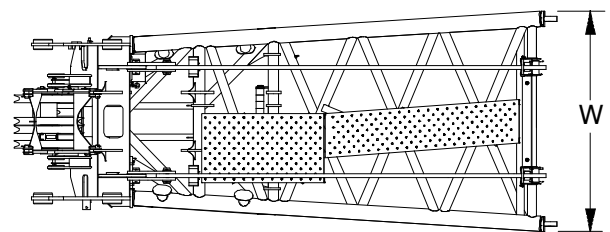
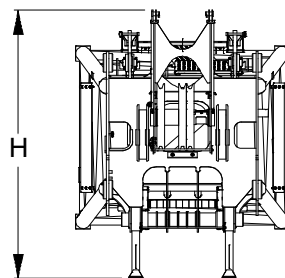

Boom/Luffing Boom

80in (2.03) x 95in (2.41m) Heavy Duty Boom/Luffing Boom Extensions

20 ft (6.10m) Extension "JC"

Length	20 ft 5.75 in	(6.24m)
Width	8 ft 5.75 in	(2.58m)
Deep	80 in	(2.03m)
Height	7 ft 9.84 in	(2.38m)
Weight	4,515 lb	(2 048kg)

Note: Weight includes pins, boom and rear post pendants and walkway.

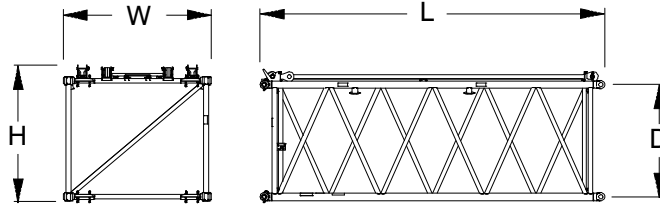

30 ft (9.14m) Extension "JC"

Length	30 ft 5.75 in	(9.14m)
Width	8 ft 5.75 in	(2.58m)
Deep	80 in	(2.03m)
Height	7 ft 9.84 in	(2.38m)
Weight	6,360 lb	(2 885kg)

Note: Weight includes pins, boom and rear post pendants, and walkway.

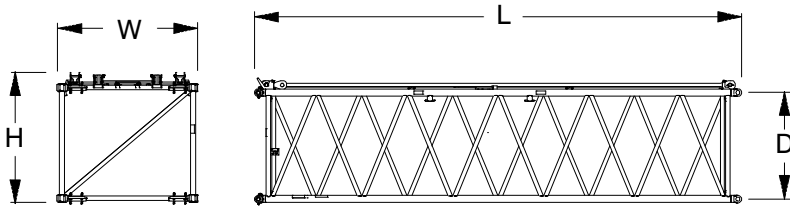

40 ft (12.19m) Extension "JC"

Length	40 ft 5.75 in	(12.19m)
Width	8 ft 5.75 in	(2.58m)
Deep	80 in	(2.03m)
Height	7 ft 9.84 in	(2.38m)
Weight	8,658 lb	(3 928kg)

Note: Weight includes pins, boom and rear post pendants, and walkway.

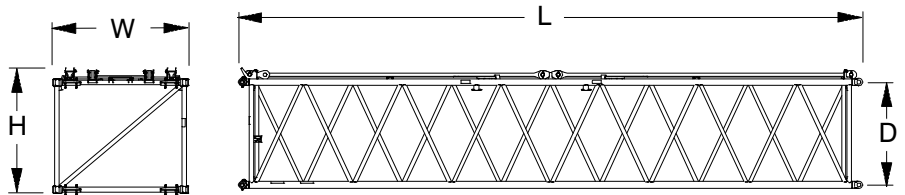

Boom/Luffing Jib

Luffing Jib Base "XX"

Transport Configuration ①

Length	31 ft 11.68 in	(9.75m)
Width	7 ft 4.96 in	(2.26m)
Depth	68 in	(1.7m)
Height	10 ft 11.31" in	(3.34m)
Weight 1†	13,116 lb	(5 949kg)

Note: Weight 1 includes pins, basic frontstay & backstay pendants, and hardware and walkways.

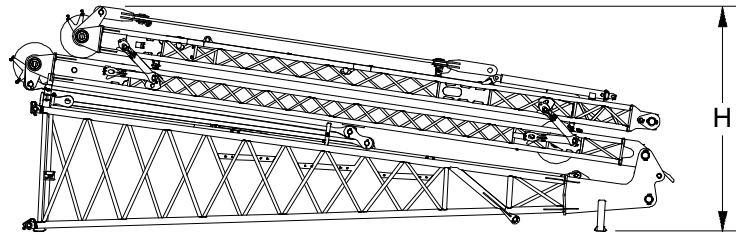
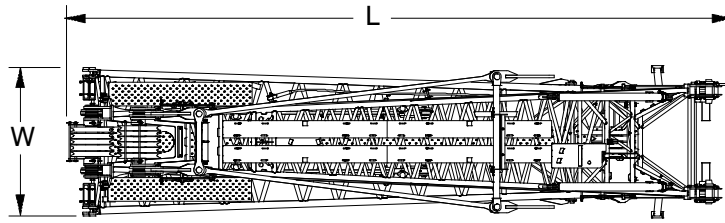

Boom/Luffing Jib

30 ft (10.3m) Long Range/

Luffing Jib Top Section "G" ①

Length	30 ft	(9.14m)
Width	7 ft	(2.1m)
Deep	68 in	(1.7m)
Height	7 ft 6.9 in	(2.3m)
Weight	5,487 lb	(2 489kg)

Note: Weight includes pins, pendants, and walkways.

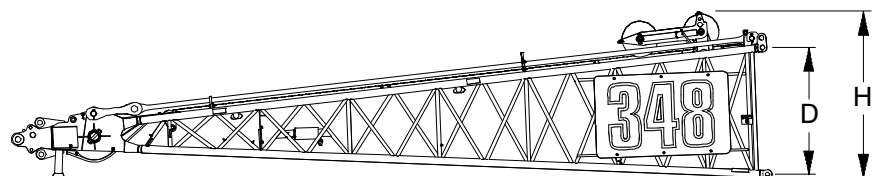
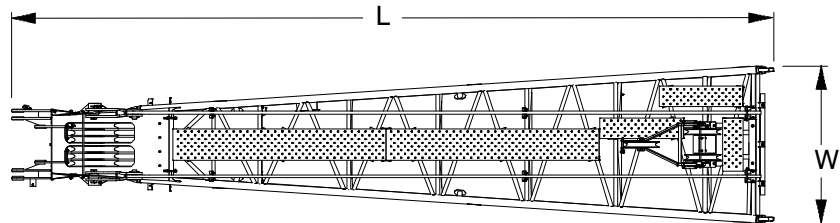

Luffing Jib Extensions

68 in (1.7) x 80 in (2.03m) Long Range Boom/Luffing Jib Extensions "FE"

10 ft (3.05m) Extension

Length	10 ft 4.63 in	(3.05m)
Width	7 ft 2.38 in	(2.19m)
Deep	68 in	(1.7m)
Height	6 ft 10.33 in	(2.09m)
Weight	1,433 lb	(650kg)

Note: Weight includes pins, boom and rear post pendants, and walkway.

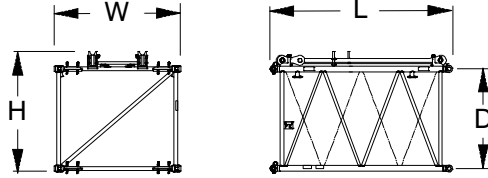

20 ft (6.10m) Extension

Length	20 ft 4.63 in	(6.10m)
Width	7 ft 2.38 in	(2.19m)
Deep	68 in	(1.7m)
Height	6 ft 10.33 in	(2.09m)
Weight	2,293 lb	(1 040kg)

Note: Weight includes pins, boom and rear post pendants, and walkway.

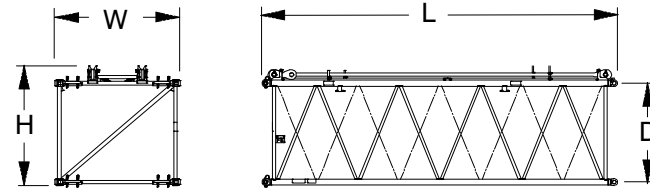

30 ft (9.14m) Extension

Length	30 ft 4.63 in	(9.14m)
Width	7 ft 2.38 in	(2.19m)
Deep	68 in	(1.7m)
Height	6 ft 10.33 in	(2.09m)
Weight	3,172 lb	(1 439kg)

Note: Weight includes pins, boom and rear post pendants, and walkway.

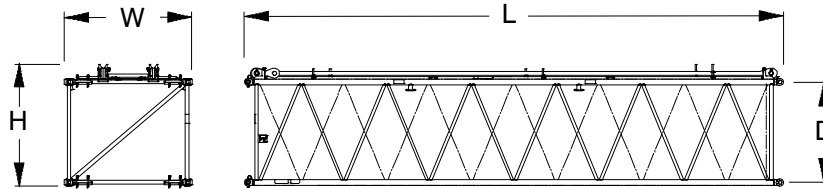

40 ft (12.19m) Extension

Length	40 ft 4.63 in	(12.31m)
Width	7 ft 2.38 in	(2.19m)
Deep	68 in	(1.7m)
Height	6 ft 10.33 in	(2.09m)
Weight	4,260 lb	(1 932kg)

Note: Weight includes pins, boom and rear post pendants, and walkway.

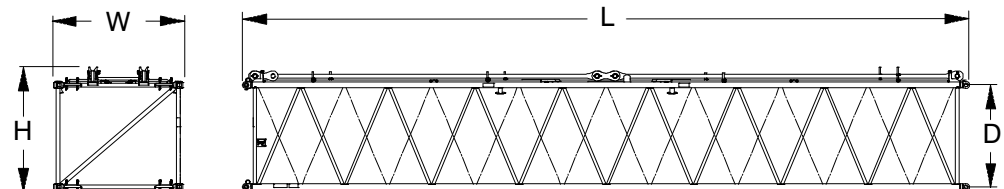

Luffing Fixed Jib

20 ft (6.10m) Fixed Jib Base and Strut "K" ①

Length	20 ft 3.2 in	(6.10m)
Width	4 ft 4.88 in	(1.34m)
Deep	39 in	(1.0m)
Height	5 ft 8.4 in	(1.7m)
Weight	2,676 lb	(1 214kg)

Note: Weight includes base section assembly, strut assembly, and connecting pins.

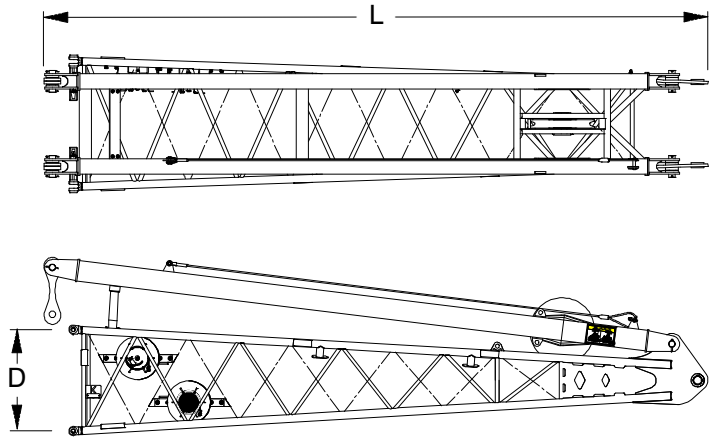
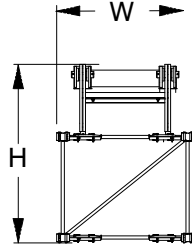

20 ft (6.10m) Fixed Jib Top Section "E" ①

Length	20 ft 1.55 in	(6.10m)
Width	5 ft 10 in	(1.78m)
Deep	39 in	(1.0m)
Height	3 ft 10.63 in	(1.18m)
Weight	1,767 lb	(802kg)

Note: Weight includes jib top assembly with head machinery, pendant links, and ATB weight.

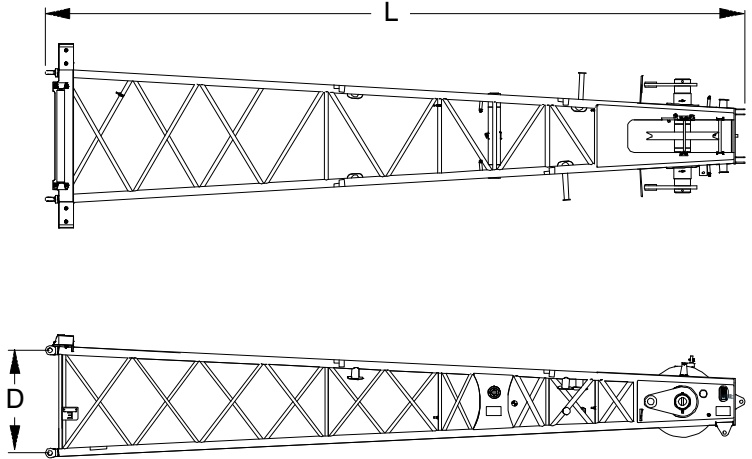
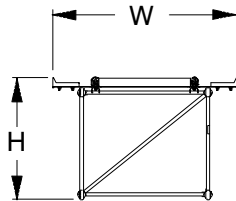

20 ft (6.10m) Fixed Jib Extension "EF" ①

Length	20 ft 3.5 in	(6.10m)
Width	5 ft 10 in	(1.78m)
Deep	39 in	(1.0m)
Height	3 ft 10.38 in	(1.18m)
Weight	1,066 lb	(484kg)

Note: Weight includes extension, pendants, wear bar, and connecting pins.

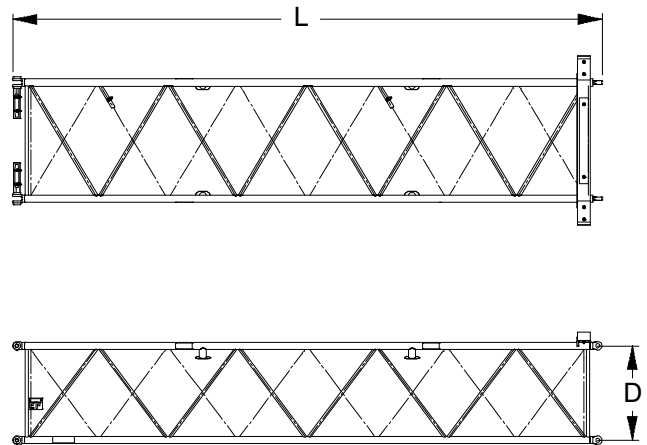
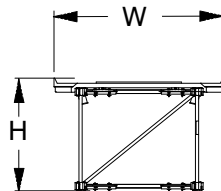

Hook Balls

20 Ton (18.1mt) Swivel Hook Ball* ❶

Width	16.14 in	(0.41m)
Height	40.61 in	(1.03m)
Weight	1,250 lb	(568kg)

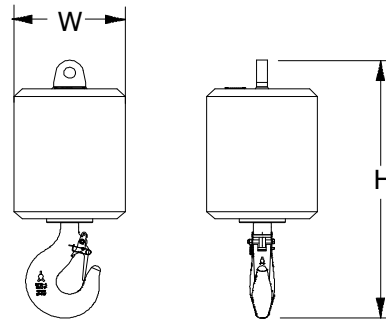

Hook Blocks

40 Ton (36.3mt) 1-Sheave Hook Block* ❶

Width1	32.69 in	(0.83m)
Width2	14.19 in	(0.36m)
Width3	12 in	(0.30m)
Height	72.63 in	(1.84m)
Weight	2,274 lb	(1 031kg)

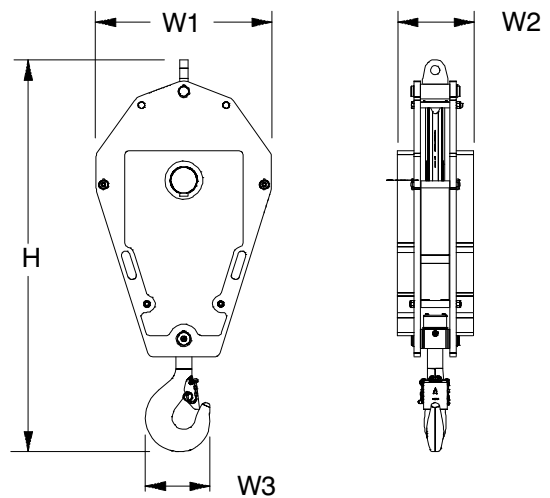

Number inside black circle “❶” = # of components
 * – Optional equipment

90 Ton (81.6mt)**3-Sheave Hook Block* ①**

Width1	32.69 in	(0.83m)
Width2	19.75 in	(0.50m)
Width3	17 in	(0.43m)
Height	82.06 in	(2.08m)
Weight	3,611 lb	(1 031kg)

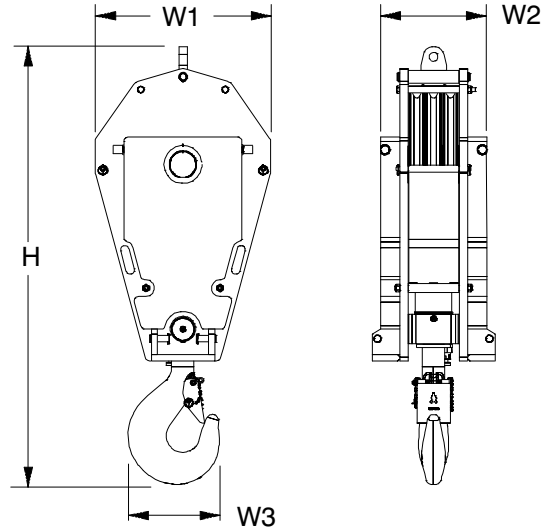
**165 Ton (150mt)****5-Sheave Hook Block* ①**

Width1	32.69 in	(0.83m)
Width2	33.25 in	(0.84m)
Width3	21.33 in	(0.54m)
Height	85.44 in	(2.17m)
Weight	5,951 lb	(2 699kg)

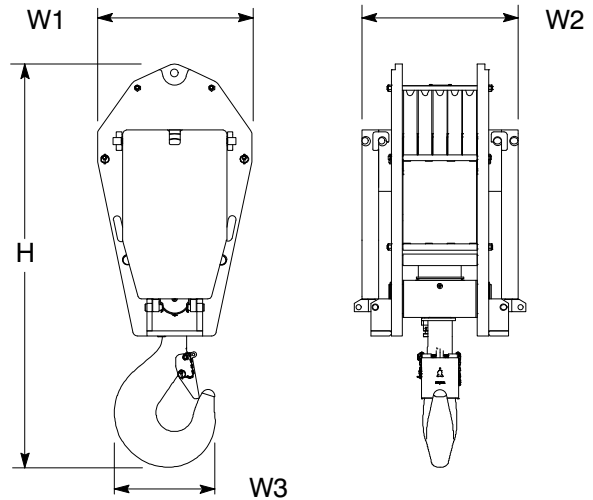

Number inside black circle "①" = # of components

* - Optional equipment

Luffing Attachment

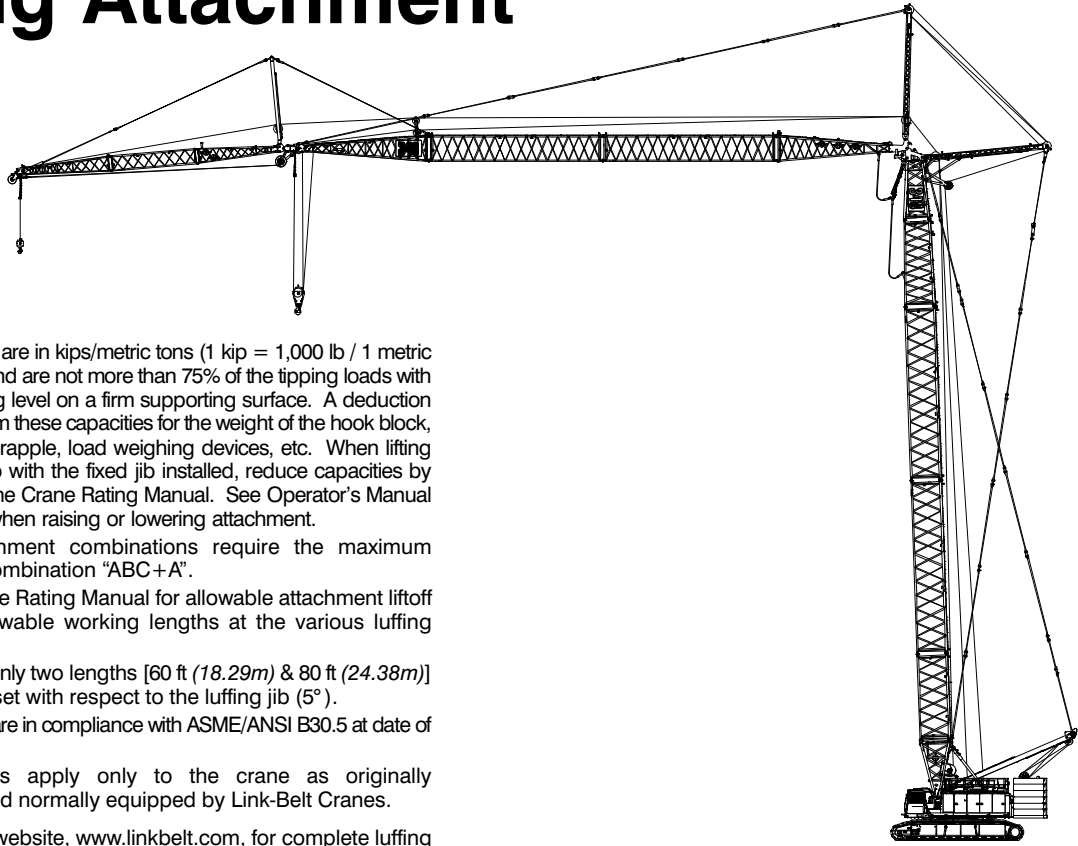

Notes:

1. Capacities shown are in kips/metric tons (1 kip = 1,000 lb / 1 metric ton = 0.45 kips) and are not more than 75% of the tipping loads with the crane standing level on a firm supporting surface. A deduction must be made from these capacities for the weight of the hook block, hook ball, sling, grapple, load weighing devices, etc. When lifting from the luffing jib with the fixed jib installed, reduce capacities by values shown in the Crane Rating Manual. See Operator's Manual for all limitations when raising or lowering attachment.
2. All luffing attachment combinations require the maximum counterweight combination "ABC+A".
3. Refer to the Crane Rating Manual for allowable attachment liftoff lengths and allowable working lengths at the various luffing boom angles.
4. The fixed jib has only two lengths [60 ft (18.29m) & 80 ft (24.38m)] and only one offset with respect to the luffing jib (5°).
5. These capacities are in compliance with ASME/ANSI B30.5 at date of manufacture.
6. These capacities apply only to the crane as originally manufactured and normally equipped by Link-Belt Cranes.

* See Link-Belt® website, www.linkbelt.com, for complete luffing attachment working range details and capacities including fixed jib and midfall.

Luffing Boom Make-up

Luffing Boom Length ft (m)	15 ft (4.6m) "N" Base Section	20 ft (6.1m) "JT" Base Extension	"JC" Extensions			20 ft (6.1m) "JR" Tapered Extension	15 ft (4.6m) "N" Luffing Boom Top Section
			20 ft (6.1m)	30 ft (9.1m)	40 ft (12.2m)		
130 (39.6)	1	1	1	—	1	1	1
140 (36.6)	1	1	—	1	1	1	1
150 (45.7)	1	1	—	—	2	1	1
160 (48.8)	1	1	1	1	1	1	1
170 (51.8)	1	1	1	—	2	1	1
180 (54.9)	1	1	—	1	2	1	1
190 (57.9)	1	1	2	—	2	1	1
200 (57.9)	1	1	1	1	2	1	1
Extensions Required to Make All Lengths	1	1	2	1	2	1	1

Chart A
Recommended Luffing Boom Make-Up

Luffing Jib Make-up

Luffing Jib Length ft (m)	30 ft (9.1m) “JE” Base Section	“FE” Extensions				30 ft (9.1m) “G” Top Section
		10 ft (3.05m)	20 ft (6.1m)	30 ft (9.1m)	40 ft (12.2m)	
100 (30.5)	1	–	–	–	1	1
110 (33.5)	1	1	–	–	1	1
120 (36.6)	1	–	1	–	1	1
130 (39.6)	1	–	–	1	1	1
140 (42.7)	1	–	–	–	2	1
150 (45.7)	1	1	–	–	2	1
160 (48.8)	1	–	1	–	2	1
170 (51.8)	1	–	–	1	2	1
180 (54.9)	1	–	–	–	3	1
190 (57.9)	1	1	–	–	3	1
200 (61.0)	1	–	1	–	3	1
210 (64.0)	1	–	–	1	3	1
220 (67.1)	1	1	–	1	3	1
230 (70.1)	1	–	1	1	3	1
240 (73.2)	1	1	1	1	3	1
Extensions Required to Make All Lengths	1	1	1	1	3	1

Note: Luffing jib extensions must be “FE”.

Chart B Recommended Luffing Jib Make-Up

Jib Length		Jib Extensions Required	Pairs Of Basic Frontstay Pendants Required	Pairs Of Frontstay Extension Pendants Required	Pairs Of Backstop Pendants Required	Pairs Of Backstop Extension Pendants Required	Extension Link Required
ft	m	20 ft (6.1m)	38.25 ft (11.7m)	20 ft (6.1m)	57.17 ft (17.4m)	20 ft (6.1m)	
60	18.3	1	1	1	1	0	2.1 ft (0.6m)
80	24.4	2	1	2	1	1	1.2 ft (0.4m)

Chart C Fixed Jib Assembly

Working Range Diagram

65° Minimum Luffing Boom Angle – 360°
Luffing Jib

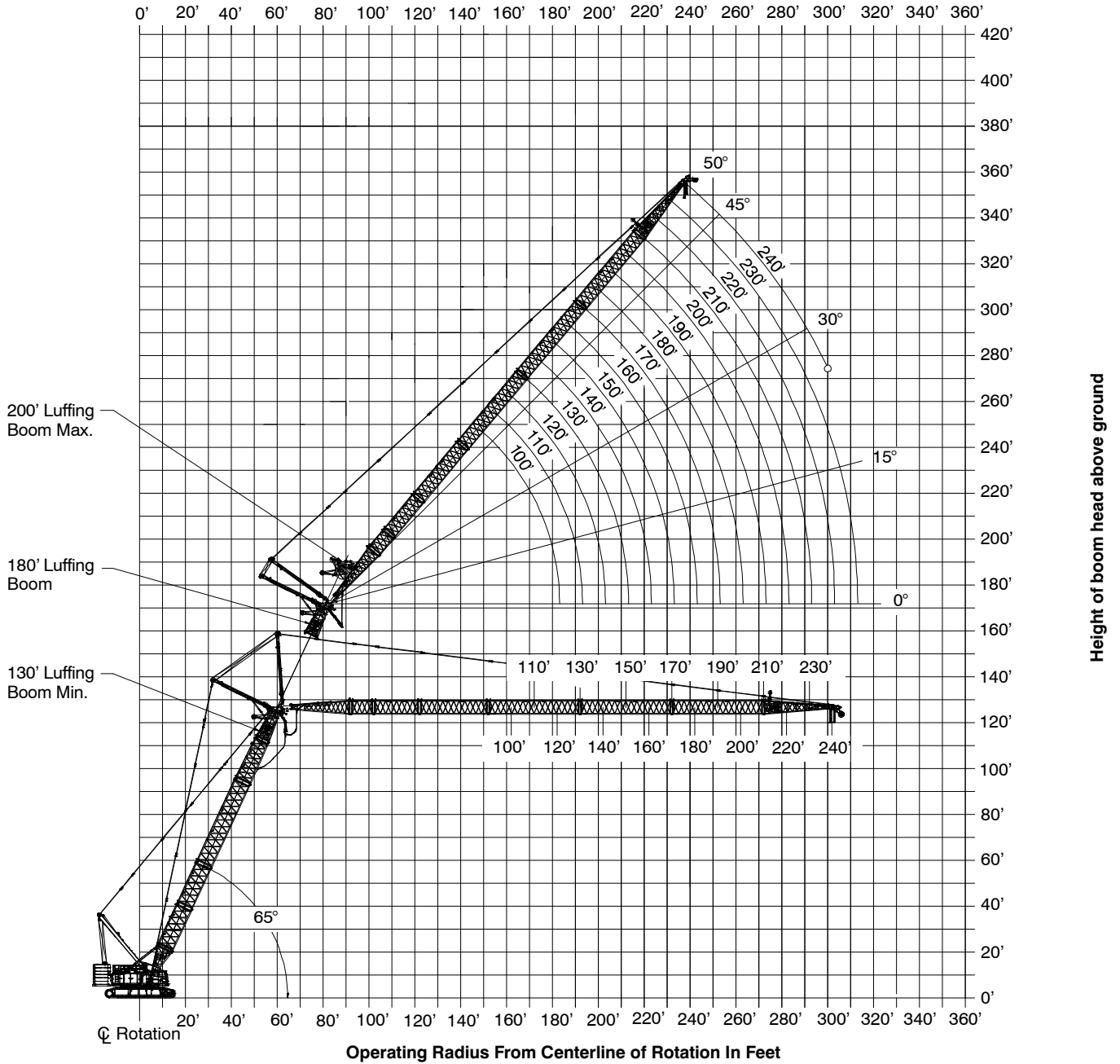

Notes:

1. Boom and jib geometry shown are for unloaded condition and crane standing level on firm surface on firm supporting surface. Boom deflection, subsequent radius, and boom angle change must be accounted for when applying load to hook.
2. Maximum and minimum luffing jib angles are equal to the values listed in the Capacity Chart for each boom length.
3. Refer to the Capacity Charts for allowable luffing boom and luffing jib combinations.

Working Range Diagram

88° Luffing Boom Angle – 360° Luffing Jib

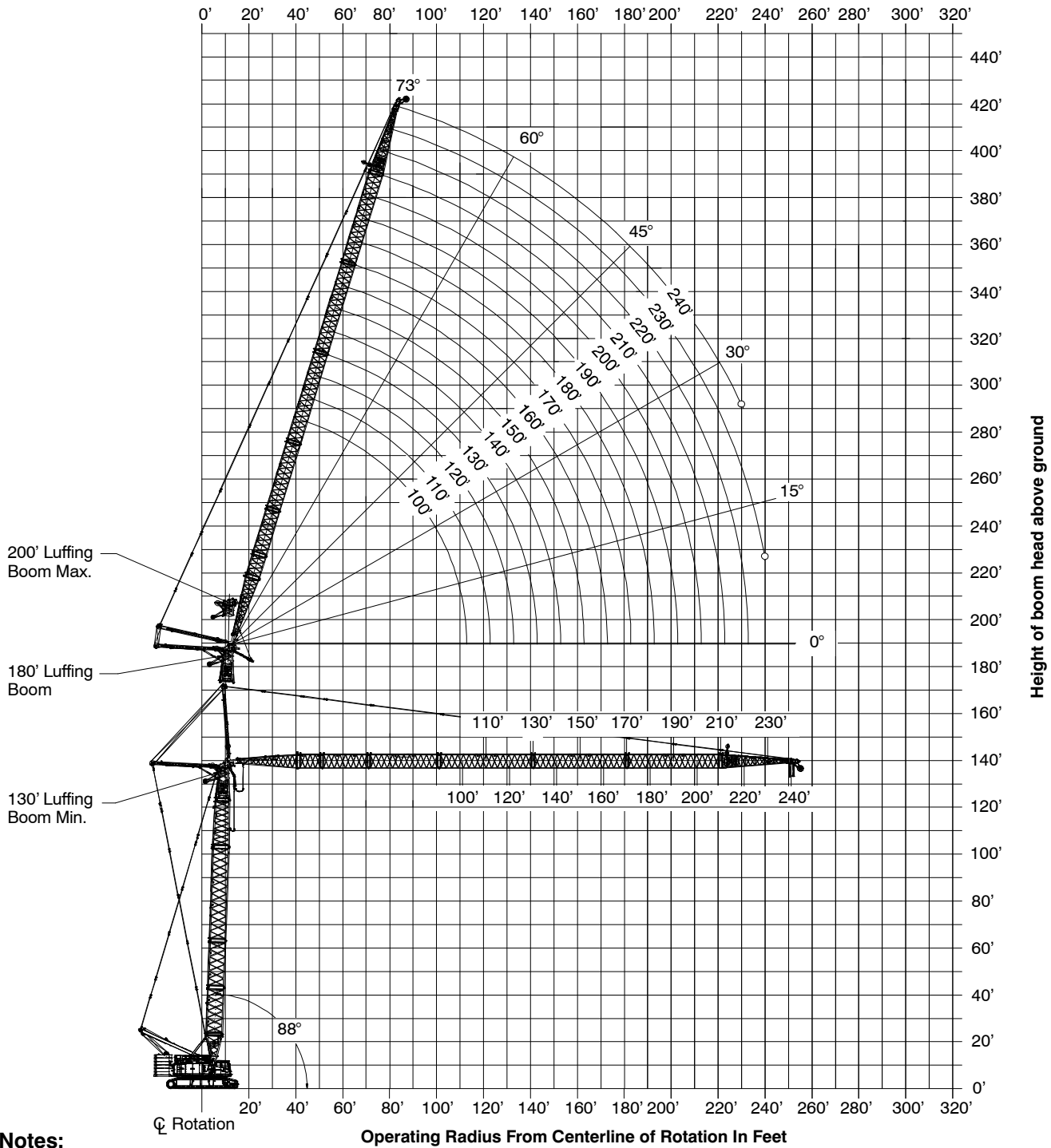

Notes:

1. Boom and jib geometry shown are for unloaded condition and crane standing level on firm surface on firm supporting surface. Boom deflection, subsequent radius, and boom angle change must be accounted for when applying load to hook.
2. Maximum and minimum luffing jib angles are equal to the values listed in the Capacity Chart for each boom length.
3. Refer to the Capacity Charts for allowable luffing boom and luffing jib combinations.

65° Luffing Boom Angle – 360° Luffing Jib + 60' Fixed Jib

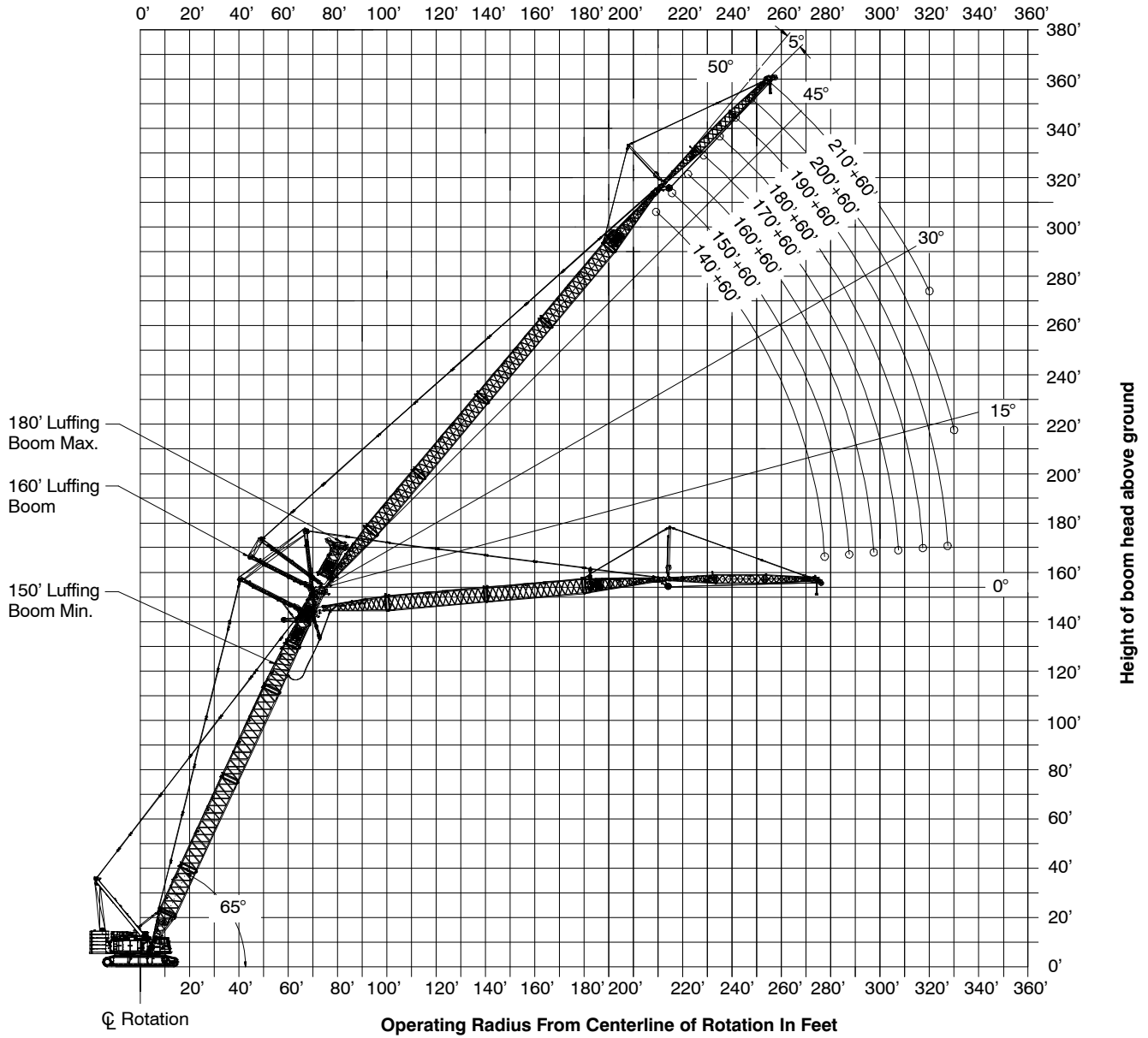

Notes:

1. Boom and jib geometry shown are for unloaded condition and crane standing level on firm surface on firm supporting surface. Boom deflection, subsequent radius, and boom angle change must be accounted for when applying load to hook.
2. Maximum and minimum luffing jib angles are equal to the values listed in the Capacity Chart for each boom length.
3. Refer to the Capacity Charts for allowable luffing boom and luffing jib combinations.

65° Luffing Boom Angle – 360° Luffing Jib + 80' Fixed Jib

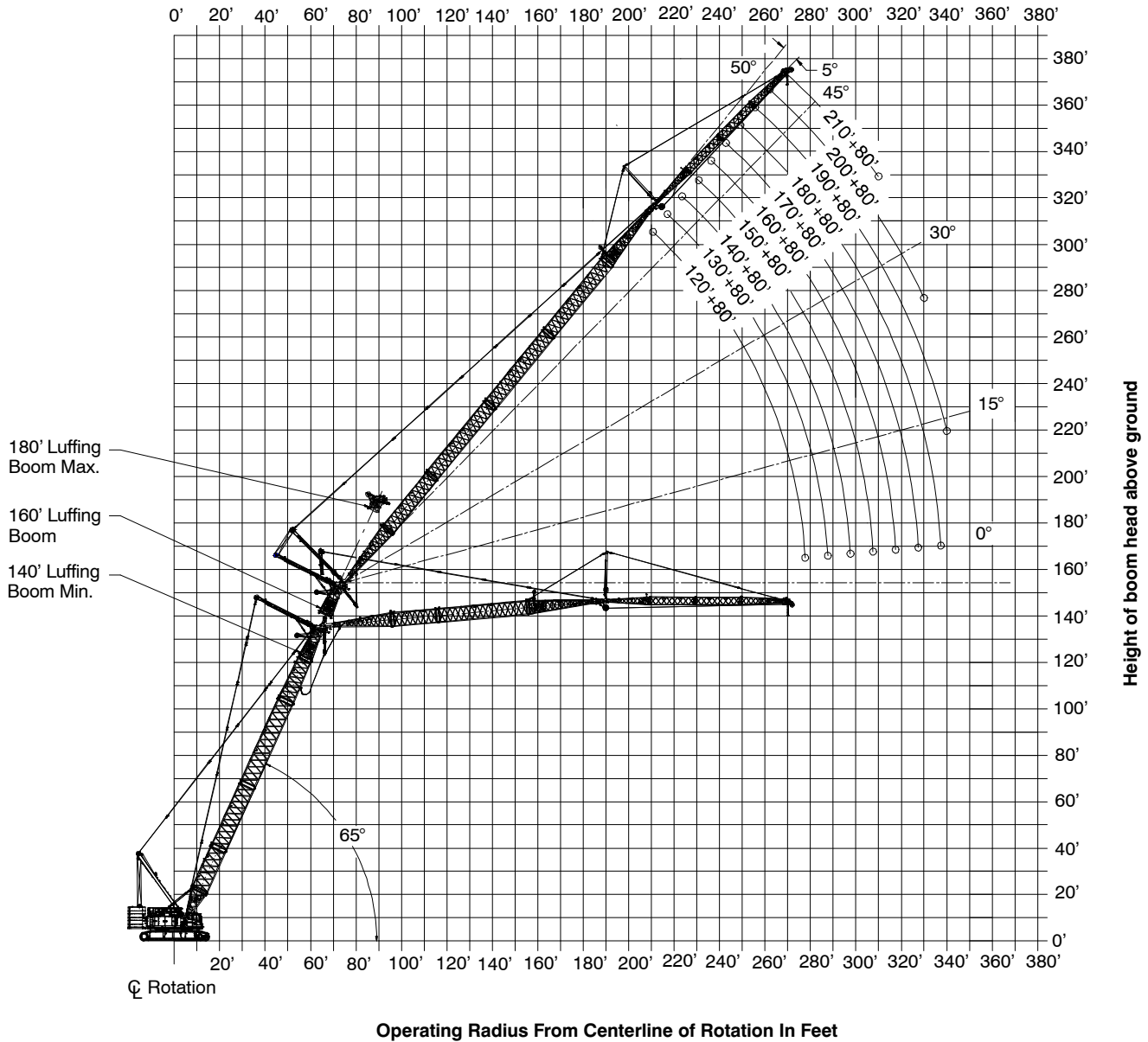

Notes:

1. Boom and jib geometry shown are for unloaded condition and crane standing level on firm surface on firm supporting surface. Boom deflection, subsequent radius, and boom angle change must be accounted for when applying load to hook.
2. Maximum and minimum luffing jib angles are equal to the values listed in the Capacity Chart for each boom length.
3. Refer to the Capacity Charts for allowable luffing boom and luffing jib combinations.

88° Luffing Boom Angle – 360° Luffing Jib + 60' Fixed Jib

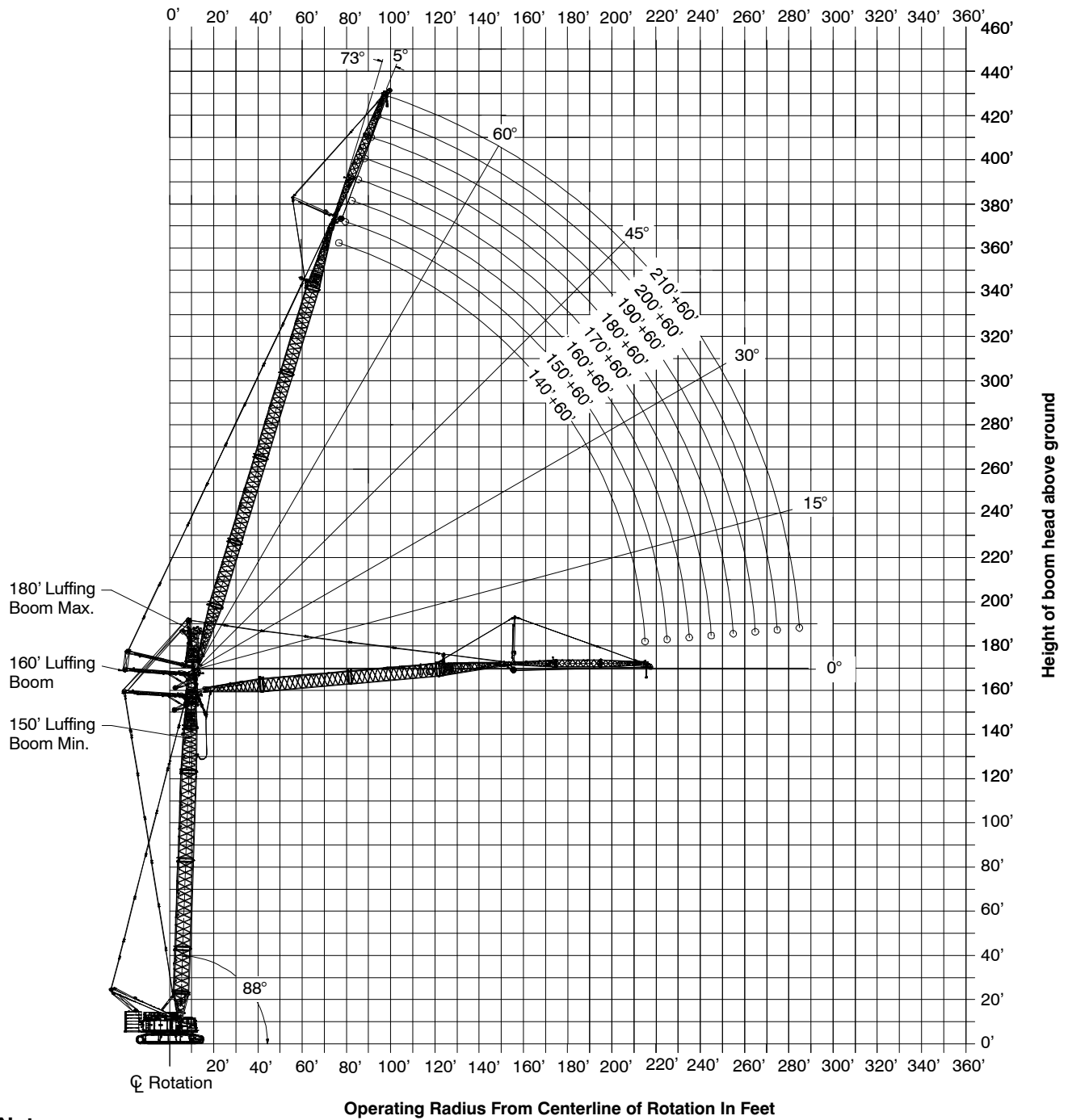

Notes:

1. Boom and jib geometry shown are for unloaded condition and crane standing level on firm surface on firm supporting surface. Boom deflection, subsequent radius, and boom angle change must be accounted for when applying load to hook.
2. Maximum and minimum luffing jib angles are equal to the values listed in the Capacity Chart for each boom length.
3. Refer to the Capacity Charts for allowable luffing boom and luffing jib combinations.

88° Luffing Boom Angle – 360° Luffing Jib + 80' Fixed Jib

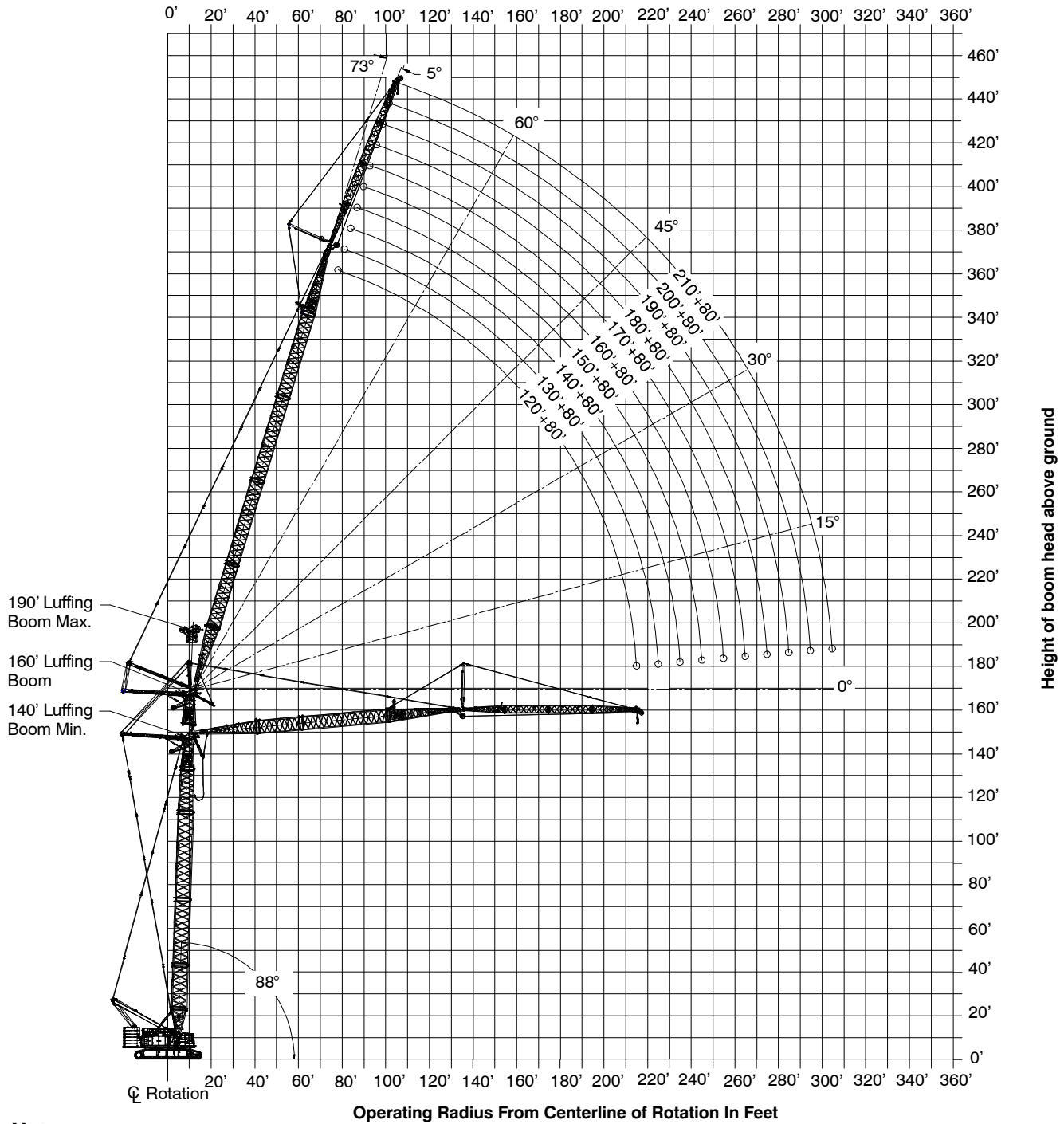

Notes:

1. Boom and jib geometry shown are for unloaded condition and crane standing level on firm surface on firm supporting surface. Boom deflection, subsequent radius, and boom angle change must be accounted for when applying load to hook.
2. Maximum and minimum luffing jib angles are equal to the values listed in the Capacity Chart for each boom length.
3. Refer to the Capacity Charts for allowable luffing boom and luffing jib combinations.

348 Series 2 - Luffing Jib Capacities - 360° Rotation																		
80" X 95" Luffing Boom, 68" X 80" Luffing Jib, Extended Gauge, ABC + A Counterweight																		
Luffing Boom Length (ft)	Luffing Boom Length (m)	Luffing Jib Length (ft)	Luffing Jib Length (m)	Load Radius (ft)	Load Radius (m)	Luffing Boom Angle												
						88°			75°			65°			Load Radius (ft)			
						Jib Angle (deg)	Tip Height (ft)	Capacity (kips)	Capacity (mt)	Jib Angle (deg)	Tip Height (ft)	Capacity (kips)	Capacity (mt)	Jib Angle (deg)		Tip Height (ft)	Capacity (kips)	Capacity (mt)
130	39.6	100	30.5	50	15.2	67.3	231.8	143.3	65.0									50
130	39.6	100	30.5	70	21.3	54.2	220.7	112	50.8									70
130	39.6	100	30.5	90	27.4	38.3	201.6	87	39.5									90
130	39.6	100	30.5	110	33.5	10.2	157.3	62.7	28.4	46.3	207	59.2	26.8					110
130	39.6	100	30.5	130	39.6					27	180	48.2	21.9	42.8	19.4			130
130	39.6	100	30.5	150	45.7									35.4	16.1			150
130	39.6	160	48.8	60	18.3	72.2	291.9	85.5	38.8									60
130	39.6	160	48.8	80	24.4	64.6	284.1	72.9	33.1									80
130	39.6	160	48.8	100	30.5	56.4	272.8	60.9	27.6									100
130	39.6	160	48.8	120	36.6	47.3	257.1	51.1	23.2									120
130	39.6	160	48.8	140	42.7	36.6	234.9	43.7	19.8	51.7	260.3	40.5	18.4					140
130	39.6	160	48.8	160	48.8	21.9	199.2	37.9	17.2	41.9	241.5	33.6	15.2					160
130	39.6	160	48.8	180	54.9					29.6	213.7	28.4	12.9	24.6	11.2			180
130	39.6	160	48.8	200	61.0					0.7	136.6	24.5	11.1	20.9	9.5			200
130	39.6	160	48.8	220	67.1									17.8	8.1			220
130	39.6	240	73.2	90	27.4	70.8	366.3	32.1	14.6									90
130	39.6	240	73.2	110	33.5	65.7	358.4	25.5	11.6									110
130	39.6	240	73.2	130	39.6	60.4	348.2	19.6	8.9									130
130	39.6	240	73.2	150	45.7	54.7	335.5	15	6.8									150
130	39.6	240	73.2	170	51.8	48.6	319.7	10.8	4.9	57.3	336.9	16.9	7.7					170
130	39.6	240	73.2	190	57.9	41.9	299.9	7.5	3.4	51.6	322.7	12.6	5.7					190
130	39.6	240	73.2	210	64.0	34.2	274.4	4.7	2.1	45.2	304.9	9	4.1					210
130	39.6	240	73.2	230	70.1	24.4	238.7	2.3	1.0	38	282.4	5.9	2.7	9.2	4.2			230
130	39.6	240	73.2	250	76.2					29.4	252.3	3.4	1.5	6.2	2.8			250
130	39.6	240	73.2	270	82.3									3.6	1.6			270

This material is supplied for reference use only. Operator must refer to in-cab Crane Rating Manual and Operator's Manual to determine allowable crane lifting capacities and assembly and operating procedures.

348 Series 2 - Luffing Jib Capacities - 360° Rotation																
80" X 95" Luffing Boom, 68" X 80" Luffing Jib, Extended Gauge, ABC + A Counterweight																
Luffing Boom Length (ft)	Luffing Boom Length (m)	Luffing Jib Length (ft)	Luffing Jib Length (m)	Load Radius (ft)	Load Radius (m)	Luffing Boom Angle										
						88°			75°			65°			Load Radius (ft)	
						Jib Angle (deg)	Tip Height (ft)	Capacity (kips)	Capacity (mt)	Jib Angle (deg)	Tip Height (ft)	Capacity (kips)	Capacity (mt)	Jib Angle (deg)		Tip Height (ft)
190	57.9	100	30.5	50	15.2	68.7	292.7	115.8	52.5							50
190	57.9	100	30.5	70	21.3	55.8	282.2	94.4	42.8							70
190	57.9	100	30.5	90	27.4	40.4	264.4	78.5	35.6							90
190	57.9	100	30.5	110	33.5	16.1	227.3	67	30.4	57.3	276.9	53	24.0			110
190	57.9	100	30.5	130	39.6					42.8	260.5	43.2	19.6			130
190	57.9	100	30.5	150	45.7					21	228.5	35.7	16.2			150
190	57.9	100	30.5	170	51.8									34.9	237.9	170
190	57.9	160	48.8	60	18.3	73	352.6	74.8	33.9							60
190	57.9	160	48.8	80	24.4	65.5	345.2	65.1	29.5							80
190	57.9	160	48.8	100	30.5	57.4	334.3	56.6	25.7							100
190	57.9	160	48.8	120	36.6	48.4	319.2	49.2	22.3	60.2	335.2	49.6	22.5			120
190	57.9	160	48.8	140	42.7	38	298	42.4	19.2	51.5	321.6	40.2	18.2			140
190	57.9	160	48.8	160	48.8	24.1	264.8	36.8	16.7	41.7	302.7	33.3	15.1			160
190	57.9	160	48.8	180	54.9					29.3	274.6	28.1	12.7			180
190	57.9	160	48.8	200	61.0					0.7	198.4	24.5	11.1	45.2	294.6	200
190	57.9	160	48.8	220	67.1									34.4	271.1	220
190	57.9	160	48.8	240	73.1									18.2	230.7	240
190	57.9	200	61.0	80	24.4	70.6	388.2	47.8	21.7							80
190	57.9	200	61.0	100	30.5	64.4	380	41.3	18.7							100
190	57.9	200	61.0	120	36.6	57.9	369	34.3	15.6							120
190	57.9	200	61.0	140	42.7	50.9	354.7	27.7	12.6							140
190	57.9	200	61.0	160	48.8	43	336	22.8	10.3	58.7	363.6	26.7	12.1			160
190	57.9	200	61.0	180	54.9	33.8	310.8	18.8	8.5	52	350	22.8	10.3			180
190	57.9	200	61.0	200	61.0	21.5	272.7	15.5	7.0	44.3	332.1	19.1	8.7			200
190	57.9	200	61.0	220	67.1					35.3	308	16.1	7.3	48.4	330.7	220
190	57.9	200	61.0	240	73.1					23.6	272.6	13.6	6.2	40.6	310.7	240
190	57.9	200	61.0	260	79.2									30.7	282.8	260
190	57.9	200	61.0	280	85.3									16.3	236.8	280

This material is supplied for reference use only. Operator must refer to in-cab Crane Rating Manual and Operator's Manual to determine allowable crane lifting capacities and assembly and operating procedures.

348 Series 2 - Luffing Jib Capacities - Over End Blocked																
80" X 95" Luffing Boom, 68" X 80" Luffing Jib, Extended Gauge, ABC + A Counterweight																
Luffing Boom Length (ft)	Luffing Boom Length (m)	Luffing Jib Length (ft)	Luffing Jib Length (m)	Load Radius (ft)	Load Radius (m)	Luffing Boom Angle						Load Radius (ft)				
						88°		75°		65°			Capacity (mt)	Capacity (kips)	Capacity (mt)	
Jib Angle (deg)	Tip Height (ft)	Capacity (kips)	Capacity (mt)	Jib Angle (deg)	Tip Height (ft)	Capacity (kips)	Capacity (mt)	Jib Angle (deg)	Tip Height (ft)	Capacity (kips)	Capacity (mt)	Jib Angle (deg)				Tip Height (ft)
130	39.6	100	30.5	50	15.2	67.3	231.8	143.3	65.0							50
130	39.6	100	30.5	70	21.3	54.2	220.7	112	50.8							70
130	39.6	100	30.5	90	27.4	38.3	201.6	91.4	41.5							90
130	39.6	100	30.5	110	33.5	10.2	157.3	62.7	28.4	46.3	207	68.5	31.1	47.1	199.9	110
130	39.6	100	30.5	130	39.6					27	180	55.4	25.1	28.8	174.6	130
130	39.6	100	30.5	150	45.7											150
130	39.6	160	48.8	60	18.3	72.2	291.9	85.5	38.8							60
130	39.6	160	48.8	80	24.4	64.6	284.1	72.9	33.1							80
130	39.6	160	48.8	100	30.5	56.4	272.8	60.9	27.6							100
130	39.6	160	48.8	120	36.6	47.3	257.1	51.1	23.2							120
130	39.6	160	48.8	140	42.7	36.6	234.9	43.7	19.8	51.7	260.3	47.4	21.5			140
130	39.6	160	48.8	160	48.8	21.9	199.2	37.9	17.2	41.9	241.5	39.5	17.9			160
130	39.6	160	48.8	180	54.9					29.6	213.7	33.5	15.2	42.7	234.9	180
130	39.6	160	48.8	200	61.0					0.7	136.6	28.7	13.0	30.7	208	200
130	39.6	160	48.8	220	67.1									9.8	153.7	220
130	39.6	240	73.1	90	27.4	70.8	366.3	32.1	14.6							90
130	39.6	240	73.1	110	33.5	65.7	358.4	25.5	11.6							110
130	39.6	240	73.1	130	39.6	60.4	348.2	19.6	8.9							130
130	39.6	240	73.1	150	45.7	54.7	335.5	15	6.8							150
130	39.6	240	73.1	170	51.8	48.6	319.7	10.8	4.9	57.3	336.9	16.9	7.7			170
130	39.6	240	73.1	190	57.9	41.9	299.9	7.5	3.4	51.6	322.7	12.6	5.7			190
130	39.6	240	73.1	210	64.0	34.2	274.4	4.7	2.1	45.2	304.9	9	4.1			210
130	39.6	240	73.1	230	70.1	24.4	238.7	2.3	1.0	38	282.4	5.9	2.7	45.7	298.2	230
130	39.6	240	73.1	250	76.2					29.4	252.3	3.4	1.5	38.6	276	250
130	39.6	240	73.1	270	82.3									30.1	246.7	270
160	48.8	100	30.5	50	15.2	68	262.3	134.9	61.2							50
160	48.8	100	30.5	70	21.3	55	251.5	109.4	49.6							70
160	48.8	100	30.5	90	27.4	39.4	233	90.3	41.0							90
160	48.8	100	30.5	110	33.5	13.6	193	65.4	29.7	52.3	242.7	65.7	29.8			110
160	48.8	100	30.5	130	39.6					35.7	221.9	53	24.0			130
160	48.8	100	30.5	150	45.7									41.5	219.9	150
160	48.8	100	30.5	170	51.8									18.5	185.2	170

This material is supplied for reference use only. Operator must refer to in-cab Crane Rating Manual and Operator's Manual to determine allowable crane lifting capacities and assembly and operating procedures.

348 Series 2 - Luffing Jib Capacities - Over End Blocked																		
80" X 95" Luffing Boom, 68" X 80" Luffing Jib, Extended Gauge, ABC + A Counterweight																		
Luffing Boom Length (ft)	Luffing Boom Length (m)	Luffing Jib Length (ft)	Luffing Jib Length (m)	Load Radius (ft)	Load Radius (m)	Luffing Boom Angle						Load Radius (ft)						
						88°			75°				65°					
						Jib Angle (deg)	Tip Height (ft)	Capacity (kips)	Capacity (mt)	Jib Angle (deg)	Tip Height (ft)		Capacity (kips)	Capacity (mt)	Jib Angle (deg)	Tip Height (ft)	Capacity (kips)	Capacity (mt)
160	48.8	160	48.8	60	18.3	72.6	322.2	81.1	36.8							60		
160	48.8	160	48.8	80	24.4	65.1	314.7	69.8	31.7							80		
160	48.8	160	48.8	100	30.5	56.9	303.6	59.5	27.0							100		
160	48.8	160	48.8	120	36.6	47.9	288.2	50.5	22.9							120		
160	48.8	160	48.8	140	42.7	37.3	266.5	43.2	19.6	55.2	295.1	45.1	20.5			140		
160	48.8	160	48.8	160	48.8	23	232.1	37.4	17.0	46	278.6	37.5	17.0			160		
160	48.8	160	48.8	180	54.9					34.9	255.2	31.7	14.4	48.8	274.2	26.2	11.9	180
160	48.8	160	48.8	200	61.0					19.1	215.9	27.2	12.3	38.7	253.7	22.7	10.3	200
160	48.8	160	48.8	220	67.1									25.2	221.6	19.4	8.8	220
160	48.8	240	73.1	90	27.4	71.1	396.6	31.2	14.1									90
160	48.8	240	73.1	110	33.5	66	388.9	25	11.3									110
160	48.8	240	73.1	130	39.6	60.7	378.9	19.6	8.9									130
160	48.8	240	73.1	150	45.7	55.1	366.3	14.9	6.8									150
160	48.8	240	73.1	170	51.8	49	350.7	10.9	4.9	59.5	370.6	18.2	8.3					170
160	48.8	240	73.1	190	57.9	42.3	331.2	7.5	3.4	53.9	357.6	14	6.3					190
160	48.8	240	73.1	210	64.0	34.7	306.1	4.7	2.1	47.8	341.4	10.3	4.7					210
160	48.8	240	73.1	230	70.1	25.1	271.3	2.3	1.0	41	320.9	7	3.2	49.7	336.8	11.1	5.0	230
160	48.8	240	73.1	250	76.2					33	294.4	4.3	2.0	43.3	318	7.9	3.6	250
160	48.8	240	73.1	270	82.3					22.8	256.6	2	0.9	35.7	293.7	5.1	2.3	270
160	48.8	240	73.1	290	88.4									26.5	260.6	2.7	1.2	290
190	57.9	100	30.5	50	15.2	68.7	292.7	115.8	52.5									50
190	57.9	100	30.5	70	21.3	55.8	282.2	94.4	42.8									70
190	57.9	100	30.5	90	27.4	40.4	264.4	78.5	35.6									90
190	57.9	100	30.5	110	33.5	16.1	227.3	67	30.4	57.3	276.9	62.5	28.3					110
190	57.9	100	30.5	130	39.6					42.8	260.5	50.8	23.0					130
190	57.9	100	30.5	150	45.7					21	228.5	42.1	19.1					150
190	57.9	100	30.5	170	51.8									34.9	237.9	28.8	13.1	170

348 Series 2 - Luffing Jib Capacities - Over End Blocked																		
80" X 95" Luffing Boom, 68" X 80" Luffing Jib, Extended Gauge, ABC + A Counterweight																		
Luffing Boom Length (ft)	Luffing Boom Length (m)	Luffing Jib Length (ft)	Luffing Jib Length (m)	Load Radius (ft)	Load Radius (m)	Luffing Boom Angle												
						88°			75°			65°			Load Radius (ft)			
						Jib Angle (deg)	Tip Height (ft)	Capacity (kips)	Capacity (mt)	Jib Angle (deg)	Tip Height (ft)	Capacity (kips)	Capacity (mt)	Jib Angle (deg)		Tip Height (ft)	Capacity (kips)	Capacity (mt)
190	57.9	160	48.8	60	18.3	73	352.6	74.8	33.9							60		
190	57.9	160	48.8	80	24.4	65.5	345.2	65.1	29.5							80		
190	57.9	160	48.8	100	30.5	57.4	334.3	56.6	25.7							100		
190	57.9	160	48.8	120	36.6	48.4	319.2	49.2	22.3							120		
190	57.9	160	48.8	140	42.7	38	298	42.4	19.2	58.3	328.9	42.4	19.2			140		
190	57.9	160	48.8	160	48.8	24.1	264.8	36.8	16.7	49.8	314.7	35.1	15.9			160		
190	57.9	160	48.8	180	54.9					39.6	294.5	29.7	13.5			180		
190	57.9	160	48.8	200	61.0					26.4	263.7	25.4	11.5	45.2	294.6	18.2	8.3	200
190	57.9	160	48.8	220	67.1									34.4	271.1	15.1	6.8	220
190	57.9	160	48.8	240	73.1									18.2	230.7	12.6	5.7	240
190	57.9	200	61.0	80	24.4		388.2	47.8	21.7									80
190	57.9	200	61.0	100	30.5		380	41.3	18.7									100
190	57.9	200	61.0	120	36.6		369	34.3	15.6									120
190	57.9	200	61.0	140	42.7		354.7	27.7	12.6									140
190	57.9	200	61.0	160	48.8		336	22.8	10.3	58.7	363.6	32.8	14.9					160
190	57.9	200	61.0	180	54.9		310.8	18.8	8.5	52	350	27.3	12.4					180
190	57.9	200	61.0	200	61.0		272.7	15.5	7.0	44.3	332.1	23.2	10.5					200
190	57.9	200	61.0	220	67.1					35.3	308	19.4	8.8	48.4	330.7	12.1	5.5	220
190	57.9	200	61.0	240	73.1					23.6	272.6	16.1	7.3	40.6	310.7	9.5	4.3	240
190	57.9	200	61.0	260	79.2									30.7	282.8	7.5	3.4	260
190	57.9	200	61.0	280	85.3									16.3	236.8	5.7	2.6	280

348 Series 2 - 60' Fixed Jib Capacities - 360° Rotation																		
80" X 95" Luffing Boom, 68" X 80" Luffing Jib, 39" X 48" Fixed Jib, Extended Gauge, ABC + A Counterweight																		
Luffing Boom Length (ft)	Luffing Boom Length (m)	Luffing Jib Length (ft)	Luffing Jib Length (m)	Load Radius (ft)	Load Radius (m)	Luffing Boom Angle												
						88°			75°			65°			Capacity (mt)	Capacity (kips)	Capacity (mt)	Load Radius (ft)
						Jib Angle (deg)	Tip Height (ft)	Capacity (kips)	Jib Angle (deg)	Tip Height (ft)	Capacity (kips)	Jib Angle (deg)	Tip Height (ft)	Capacity (kips)				
150	45.7	140	42.7	80	24.4	71.9	351.1	41.4	18.8									80
150	45.7	140	42.7	120	36.6	59.4	331.9	32.4	14.7									120
150	45.7	140	42.7	160	48.8	44.8	299.1	25.6	11.6	57.2	322.2	29.9	13.6					160
150	45.7	140	42.7	200	61.0	24	237.5	21.2	9.6	42.3	286.8	22.9	10.4					200
150	45.7	140	42.7	240	73.1					19	215.1	17	7.7	35.2	257.3	13	5.9	240
150	45.7	160	48.8	90	27.4	70.8	368.7	36.8	16.7									90
150	45.7	160	48.8	130	39.6	59.5	349.2	30.1	13.7									130
150	45.7	160	48.8	170	51.8	46.4	317.6	24.4	11.1	57.5	339.5	27.6	12.5					170
150	45.7	160	48.8	210	64.0	29	263.3	20.7	9.4	44.1	305.6	20.2	9.2					210
150	45.7	160	48.8	250	76.2					25.4	245.1	14.8	6.7	38	277.8	10.9	4.9	250
150	45.7	160	48.8	290	88.4									12.5	187.6	7.5	3.4	290
150	45.7	190	57.9	100	30.5	70.8	397	31.6	14.3									100
150	45.7	190	57.9	140	42.7	60.9	378.2	26	11.8									140
150	45.7	190	57.9	180	54.9	49.7	349.3	21.8	9.9	59.2	368.8	24.2	11.0					180
150	45.7	190	57.9	220	67.1	36.1	304.5	18.8	8.5	47.8	338.1	17	7.7					220
150	45.7	190	57.9	260	79.2	13.3	212.9	13.5	6.1	33.6	289.7	12.1	5.5	42.9	313	8	3.6	260
150	45.7	190	57.9	300	91.4									26.4	252.5	4.9	2.2	300
180	54.9	140	42.7	80	24.4	72.2	381.4	38.5	17.5									80
180	54.9	140	42.7	120	36.6	59.8	362.5	30.4	13.8									120
180	54.9	140	42.7	160	48.8	45.3	330.3	24	10.9	59.9	356.2	29.2	13.2					160
180	54.9	140	42.7	200	61.0	24.9	270.3	19.8	9.0	45.6	324.4	21.1	9.6					200
180	54.9	140	42.7	240	73.1					25.3	265.1	15.4	7.0	41.2	301.6	10.3	4.7	240
180	54.9	140	42.7	280	85.3									16.6	224.6	7	3.2	280
180	54.9	160	48.8	90	27.4	71.1	399.1	34.8	15.8									90
180	54.9	160	48.8	130	39.6	59.8	379.9	28.5	12.9									130
180	54.9	160	48.8	170	51.8	46.8	348.7	23.1	10.5	59.9	373.5	25.2	11.4					170
180	54.9	160	48.8	210	64.0	29.7	295.6	19.6	8.9	47.1	342.7	18.3	8.3					210
180	54.9	160	48.8	250	76.2					30	290	13.2	6.0	43.2	320.7	8	3.6	250
180	54.9	160	48.8	290	88.4									23.9	257.2	5	2.3	290

348 Series 2 - 60' Fixed Jib Capacities - 360° Rotation																		
80" X 95" Luffing Boom, 68" X 80" Luffing Jib, 39" X 48" Fixed Jib, Extended Gauge, ABC + A Counterweight																		
Luffing Boom Length (ft)	Luffing Boom Length (m)	Luffing Jib Length (ft)	Luffing Jib Length (m)	Load Radius (ft)	Load Radius (m)	Luffing Boom Angle						Load Radius (ft)						
						88°			75°				65°					
						Jib Angle (deg)	Tip Height (ft)	Capacity (kips)	Capacity (mt)	Jib Angle (deg)	Tip Height (ft)	Capacity (kips)	Capacity (mt)	Jib Angle (deg)	Tip Height (ft)	Capacity (kips)	Capacity (mt)	
180	54.9	190	57.9	100	30.5	71.1	427.3	28.5	12.9									100
180	54.9	190	57.9	140	42.7	61.2	408.9	24.9	11.3									140
180	54.9	190	57.9	180	54.9	50.1	380.3	20.9	9.5									180
180	54.9	190	57.9	220	67.1	36.6	336.3	18	8.2	50.3	374.2	15.2	6.9					220
180	54.9	190	57.9	260	79.2	14.6	248.3	13.7	6.2	36.8	330.4	10.5	4.8	46.9	353.2	5.1	2.3	260
180	54.9	190	57.9	300	91.4					15.1	243.6	7.1	3.2	32.6	303.5	2.4	1.1	300

348 Series 2 - 80' Fixed Jib Capacities - 360° Rotation																
80" X 95" Luffing Boom, 68" X 80" Luffing Jib, 39" X 48" Fixed Jib, Extended Gauge, ABC + A Counterweight																
Luffing Boom Length (ft)	Luffing Boom Length (m)	Luffing Jib Length (ft)	Luffing Jib Length (m)	Load Radius (ft)	Load Radius (m)	Luffing Boom Angle						Load Radius (ft)				
						88°			75°				65°			
						Jib Angle (deg)	Tip Height (ft)	Capacity (kips)	Capacity (mt)	Jib Angle (deg)	Tip Height (ft)		Capacity (kips)	Capacity (mt)	Jib Angle (deg)	Tip Height (ft)
160	48.8	210	64.0	110	33.5	71.9	446	22	10.0							110
160	48.8	210	64.0	150	45.7	63.4	428.6	18.5	8.4							150
160	48.8	210	64.0	190	57.9	54.2	403.1	15.6	7.1							190
160	48.8	210	64.0	230	70.1	43.6	366.5	13.3	6.0	53.2	394.1	13.9	6.3			230
160	48.8	210	64.0	270	82.3	30.1	310.4	11.6	5.3	42.4	356.1	9.3	4.2	49.6	372.5	270
160	48.8	210	64.0	310	94.5					28.4	296.9	6.1	2.8	38.2	329.2	310
160	48.8	210	64.0	340	103.6					8.2	198.5	4.3	2.0			340
190	57.9	120	36.6	80	24.4	72.8	391.5	33.7	15.3							80
190	57.9	120	36.6	120	36.6	60.4	372.7	23.6	10.7							120
190	57.9	120	36.6	160	48.8	45.9	340.6	17.7	8.0							160
190	57.9	120	36.6	200	61.0	25.6	280.9	13.9	6.3	47.1	336.6	17	7.7			200
190	57.9	120	36.6	240	73.1					27.5	280.3	13.5		43.6	315.6	240
190	57.9	120	36.6	280	85.3									21.2	247.5	280
190	57.9	130	39.6	90	27.4	70.8	398.5	31.3	14.2							90
190	57.9	130	39.6	130	39.6	58.8	378.2	22.8	10.3							130
190	57.9	130	39.6	170	51.8	44.8	344.6	17.5	7.9	59.6	373	21.9	9.9			170
190	57.9	130	39.6	210	64.0	24.9	283.1	14.2	6.4	45.9	340.7	17	7.7			210
190	57.9	130	39.6	250	76.2					26.9	282.6	13.8	6.3	42.5	319.4	250
190	57.9	130	39.6	290	88.4									20.6	249.1	290
190	57.9	140	42.7	90	27.4	71.7	409.2	32.4	14.7							90
190	57.9	140	42.7	130	39.6	60.4	390.1	23.4	10.6							130
190	57.9	140	42.7	170	51.8	47.4	359	18.2	8.3							170
190	57.9	140	42.7	210	64.0	30.3	306.1	14.9	6.8	48.4	354.8	17.8	8.1			210
190	57.9	140	42.7	250	76.2					31.8	304.2	13.7	6.2	45.3	324.3	250
190	57.9	140	42.7	290	88.4									27	275.8	290

This material is supplied for reference use only. Operator must refer to in-cab Crane Rating Manual and Operator's Manual to determine allowable crane lifting capacities and assembly and operating procedures.

This Page Intentionally Blank

Link-Belt Cranes Lexington, Kentucky www.linkbelt.com

®Link-Belt is a registered trademark. Copyright 2023. We are constantly improving our products and therefore reserve the right to change designs and specifications.